

PANDUIT PART NUMBER	WEIGHT
FR24TBE12 FR24TBE12M	4.12 LB/EACH (1869g/EACH)

NOTES:

1. SEE CURRENT CATALOG FOR ADDITIONAL PART SUFFIXES TO INDICATE PACKAGE QUANTITY.
2. THE FIBERRUNNER 24x4 QUIKLOCK TRAPEZE BRACKET IS USED TO SUPPORT THE FIBERRUNNER 24x4 CABLE ROUTING SYSTEM BETWEEN TWO (2) SECTIONS OF EXISTING 1/2" (M12) THREADED ROD THAT ARE 27" (685.8) - 31.5" (800.1) APART.
3. THE FIBERRUNNER 24x4 QUIKLOCK TRAPEZE BRACKET - EXISTING 1/2" (M12) THREADED ROD INCLUDES: ONE (1) BRACKET ASSEMBLY, FOUR (4) 1/2-13 SPLIT LOCK NUTS (FR24TBE12 ONLY), FOUR (4) M12x1.75 SPLIT LOCK NUTS (FR24TBE12M ONLY).
4. FINISH COLOR: BLACK (EXCEPT FOR HARDWARE)
5. DIMENSIONS IN PARENTHESES ARE IN METRIC.

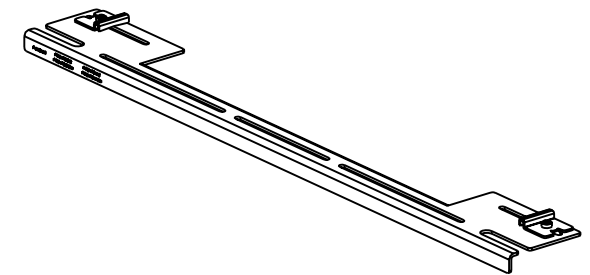
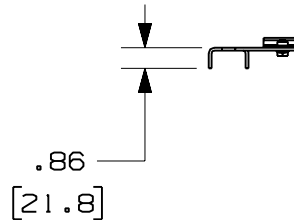
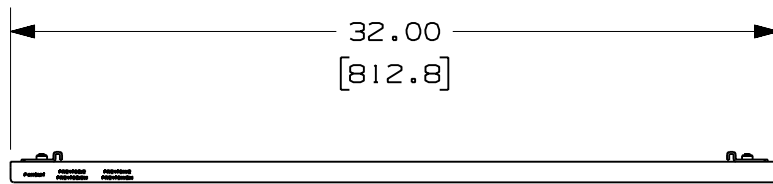
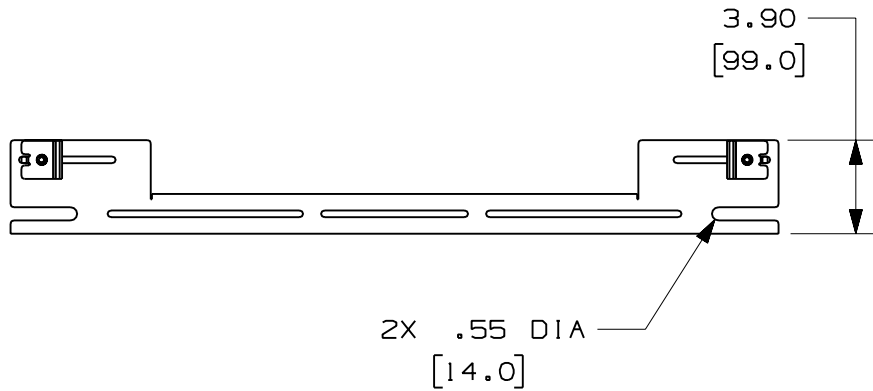

ENG. REF.: D39701CR_DC/00 FR24TBE12

CAD FILENAME/LAYERS: FR24TBE12.pdf

PANDUIT CORP TINLEY PARK, ILLINOIS
 FIBERRUNNER 24x4 QUIKLOCK TRAPEZE BRACKET - EXISTING 1/2" (M12) THREADED ROD (FR24TBE12, FR24TBE12M)
 CUSTOMER DRAWING

UNLESS OTHERWISE SPECIFIED, DIMENSIONAL TOLERANCES ARE:
 (.X) ± (.XXX) ±
 (.XX) ± .03 (.8) ANGLES ±

UNLESS OTHERWISE SPECIFIED, ALL DIMENSIONS ARE GIVEN IN INCHES, THIRD ANGLE PROJECTION.

DRAWN BY: MSO	MAT'L: STEEL	SCALE: NONE
DATE: 10-21-08		DRAWING NO. 39701-47
CHK'D: SL		DWG SIZE: A

REV	DATE	BY	CHK	DESCRIPTION	ECN	R	CUST	SUP	GMBH
R	10-21-08	MSO	SL	RELEASED TO PRODUCTION	39701-47	RN	RN		